

# No.5

## THE TOWER

### FLOOR SIXTEEN RESIDENCE B

Four Bedrooms  
Four Bathrooms  
Powder Room

#### INTERIOR

4,600 square feet  
427 square meters

#### EXTERIOR

962 square feet  
89 square meters

#### TOTAL

5,562 square feet  
516 square meters  
139'-9" linear feet of glass

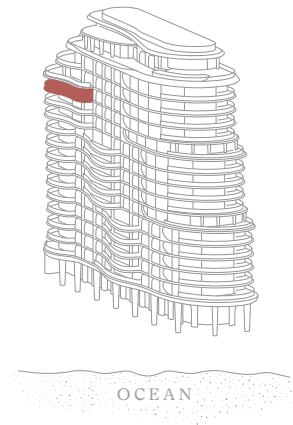

Stated square footages and dimensions are measured to the exterior boundaries of the exterior walls and the centerline of interior demising walls and in fact vary from the square footage and dimensions that would be determined by using the description and definition of the "Unit" set forth in the Declaration (which generally only includes the interior airspace between the perimeter walls and excludes all interior structural components and other common elements). This method is generally used in sales materials and is provided to allow a prospective buyer to compare the Units with units in other condominium projects that utilize the same method. For your reference, the area of the Unit, determined in accordance with these defined unit boundaries is described on Exhibit 3 to the Declaration. Measurements of rooms set forth on this floor plan are generally taken at the farthest points of each given room (as if the room were a perfect rectangle), without regard for any cutouts or variations. Accordingly, the area of the actual room will typically be smaller than the product obtained by multiplying the stated length and width. All dimensions are estimates which will vary with actual construction, and all floor plans, specifications and other development plans are subject to change and will not necessarily accurately reflect the final plans and specifications for the development.

0' 4' 8' 16'



# No. 7

## THE TOWER

### FLOOR FIFTEEN RESIDENCE B

Four Bedrooms  
Four Bathrooms  
Powder Room

#### INTERIOR

4,600 square feet  
427 square meters

#### EXTERIOR

962 square feet  
89 square meters

#### TOTAL

5,562 square feet  
516 square meters  
151'-6" linear feet of glass

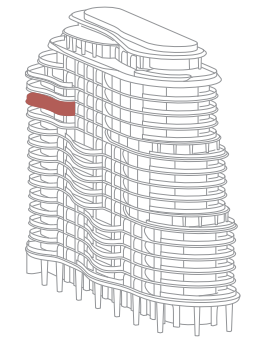

OCEAN



Stated square footages and dimensions are measured to the exterior boundaries of the exterior walls and the centerline of interior demising walls and in fact vary from the square footage and dimensions that would be determined by using the description and definition of the "Unit" set forth in the Declaration (which generally only includes the interior airspace between the perimeter walls and excludes all interior structural components and other common elements). This method is generally used in sales materials and is provided to allow a prospective buyer to compare the Units with units in other condominium projects that utilize the same method. For your reference, the area of the Unit, determined in accordance with these defined unit boundaries is described on Exhibit 3 to the Declaration. Measurements of rooms set forth on this floor plan are generally taken at the farthest points of each given room (as if the room were a perfect rectangle), without regard for any cutouts or variations. Accordingly, the area of the actual room will typically be smaller than the product obtained by multiplying the stated length and width. All dimensions are estimates which will vary with actual construction, and all floor plans, specifications and other development plans are subject to change and will not necessarily accurately reflect the final plans and specifications for the development.

0' 4' 8' 16'



# No. 9

## THE TOWER

### FLOOR FOURTEEN RESIDENCE B

Four Bedrooms  
Four Bathrooms  
Powder Room

#### INTERIOR

4,600 square feet  
427 square meters

#### EXTERIOR

962 square feet  
89 square meters

#### TOTAL

5,562 square feet  
516 square meters  
151'-6" linear feet of glass

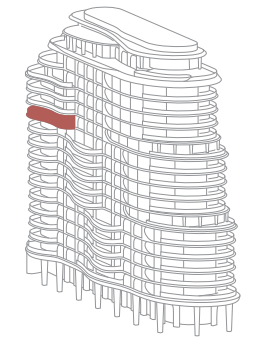
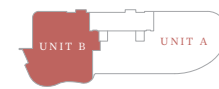

OCEAN



Stated square footages and dimensions are measured to the exterior boundaries of the exterior walls and the centerline of interior demising walls and in fact vary from the square footage and dimensions that would be determined by using the description and definition of the "Unit" set forth in the Declaration (which generally only includes the interior airspace between the perimeter walls and excludes all interior structural components and other common elements). This method is generally used in sales materials and is provided to allow a prospective buyer to compare the Units with units in other condominium projects that utilize the same method. For your reference, the area of the Unit, determined in accordance with these defined unit boundaries is described on Exhibit 3 to the Declaration. Measurements of rooms set forth on this floor plan are generally taken at the farthest points of each given room (as if the room were a perfect rectangle), without regard for any cutouts or variations. Accordingly, the area of the actual room will typically be smaller than the product obtained by multiplying the stated length and width. All dimensions are estimates which will vary with actual construction, and all floor plans, specifications and other development plans are subject to change and will not necessarily accurately reflect the final plans and specifications for the development.

0' 4' 8' 16'



# No. 10

## THE TOWER

### FLOOR TWELVE RESIDENCE A

Five Bedrooms  
Six Bathrooms  
Powder Room  
Staff Room

### INTERIOR

4,693 square feet  
436 square meters

### EXTERIOR

649 square feet  
60 square meters

### TOTAL

5,342 square feet  
496 square meters  
161'-1" linear feet of glass

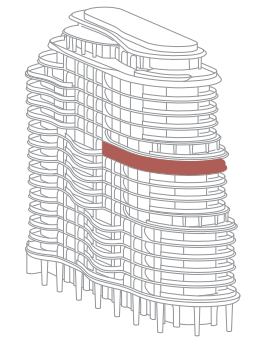
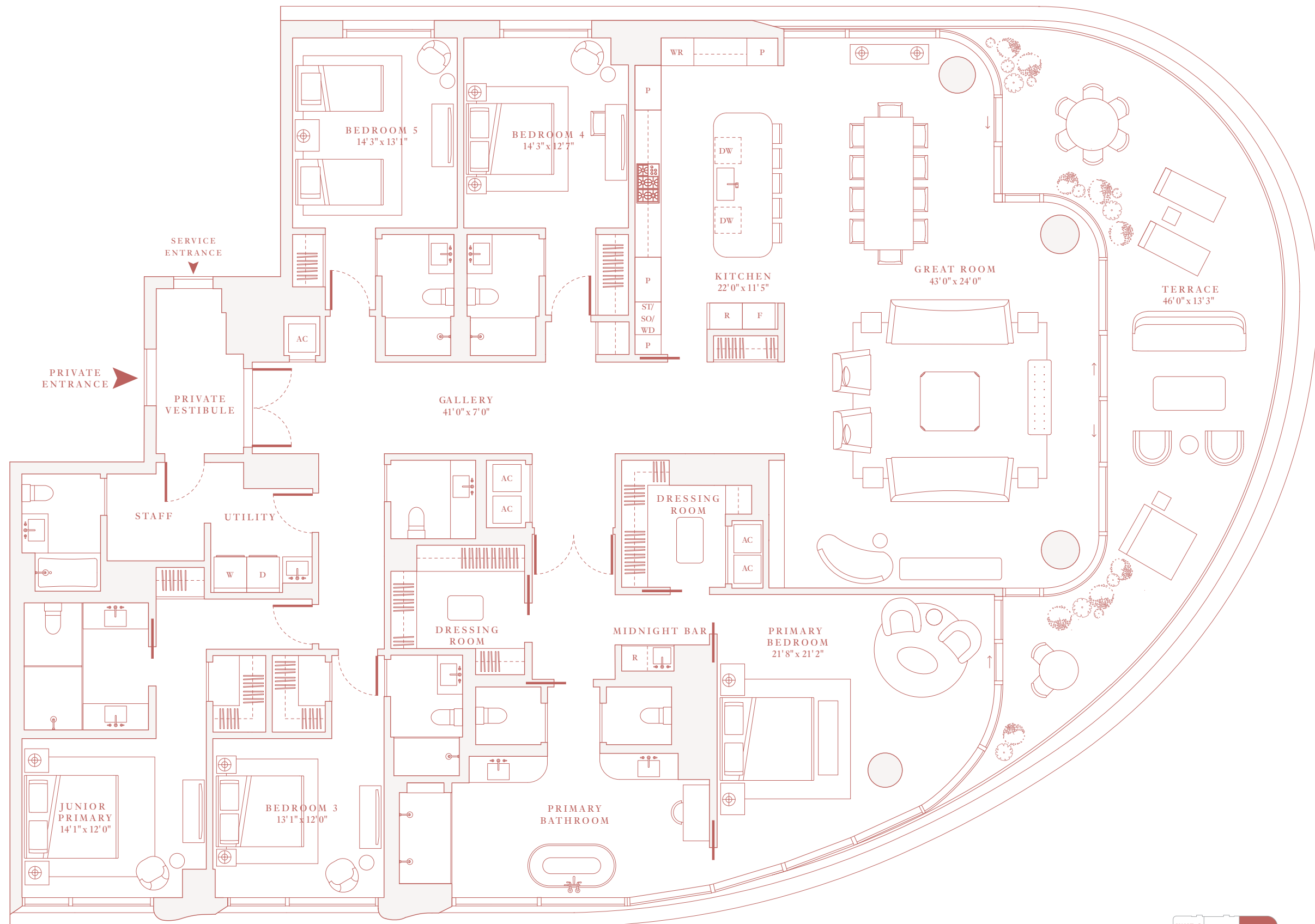

OCEAN



Stated square footages and dimensions are measured to the exterior boundaries of the exterior walls and the centerline of interior demising walls and in fact vary from the square footage and dimensions that would be determined by using the description and definition of the "Unit" set forth in the Declaration (which generally only includes the interior airspace between the perimeter walls and excludes all interior structural components and other common elements). This method is generally used in sales materials and is provided to allow a prospective buyer to compare the Units with units in other condominium projects that utilize the same method. For your reference, the area of the Unit, determined in accordance with these defined unit boundaries is described on Exhibit 3 to the Declaration. Measurements of rooms set forth on this floor plan are generally taken at the farthest points of each given room (as if the room were a perfect rectangle), without regard for any cutouts or variations. Accordingly, the area of the actual room will typically be smaller than the product obtained by multiplying the stated length and width. All dimensions are estimates which will vary with actual construction, and all floor plans, specifications and other development plans are subject to change and will not necessarily accurately reflect the final plans and specifications for the development.



# No. 12

## THE TOWER

### FLOOR TWELVE RESIDENCE C

Three Bedrooms  
Three Bathrooms  
Powder Room

### INTERIOR

3,426 square feet  
318 square meters

### EXTERIOR

395 square feet  
37 square meters

### TOTAL

3,821 square feet  
355 square meters  
129'-9" linear feet of glass

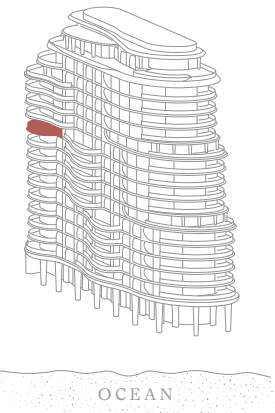
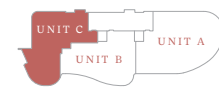
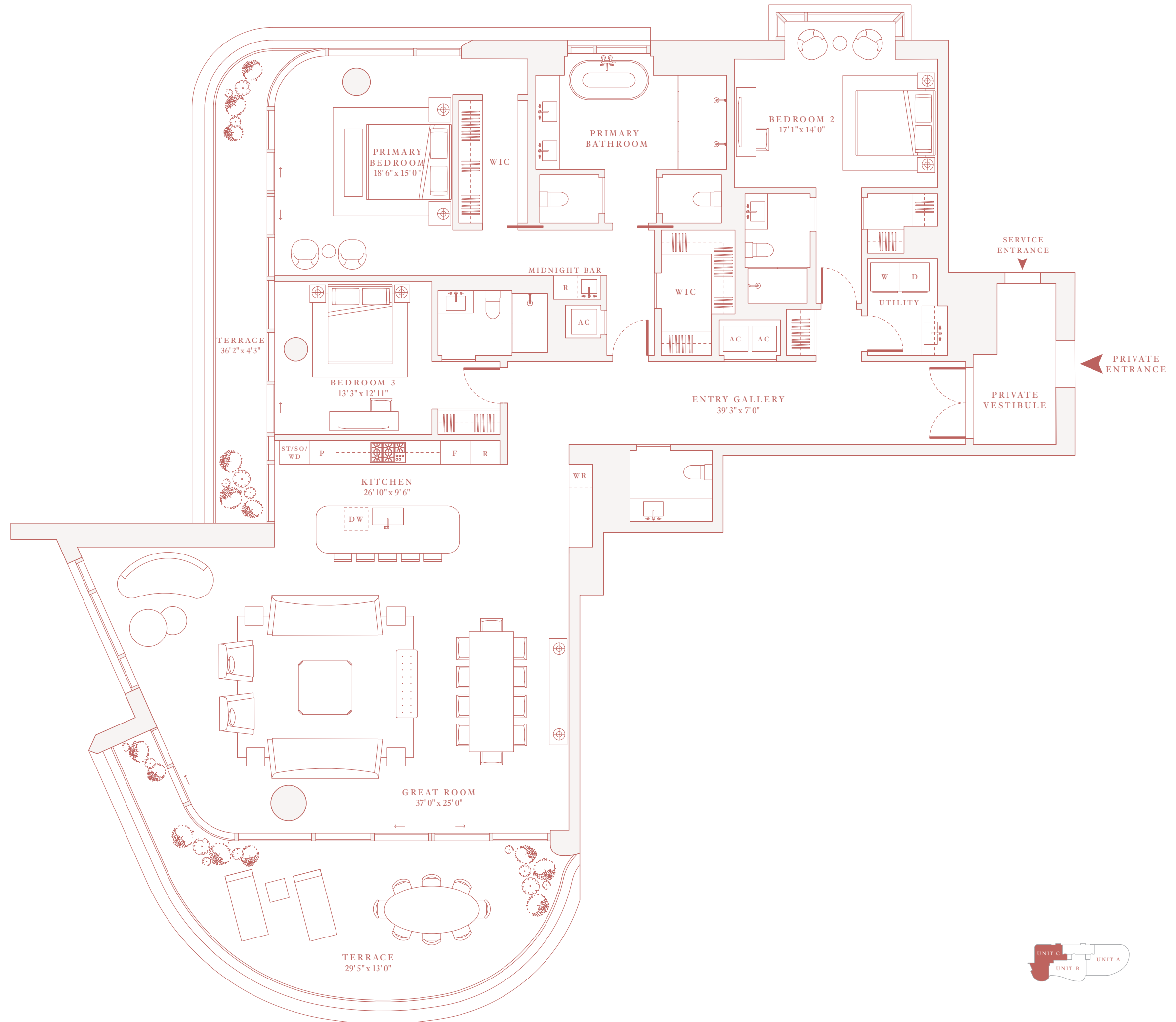

OCEAN



# No. 15

## THE TOWER

### FLOOR ELEVEN RESIDENCE C

Three Bedrooms  
Three Bathrooms  
Powder Room

### INTERIOR

3,426 square feet  
318 square meters

### EXTERIOR

395 square feet  
37 square meters

### TOTAL

3,821 square feet  
355 square meters  
129'-9" linear feet of glass

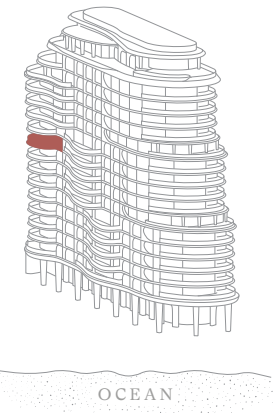
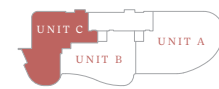
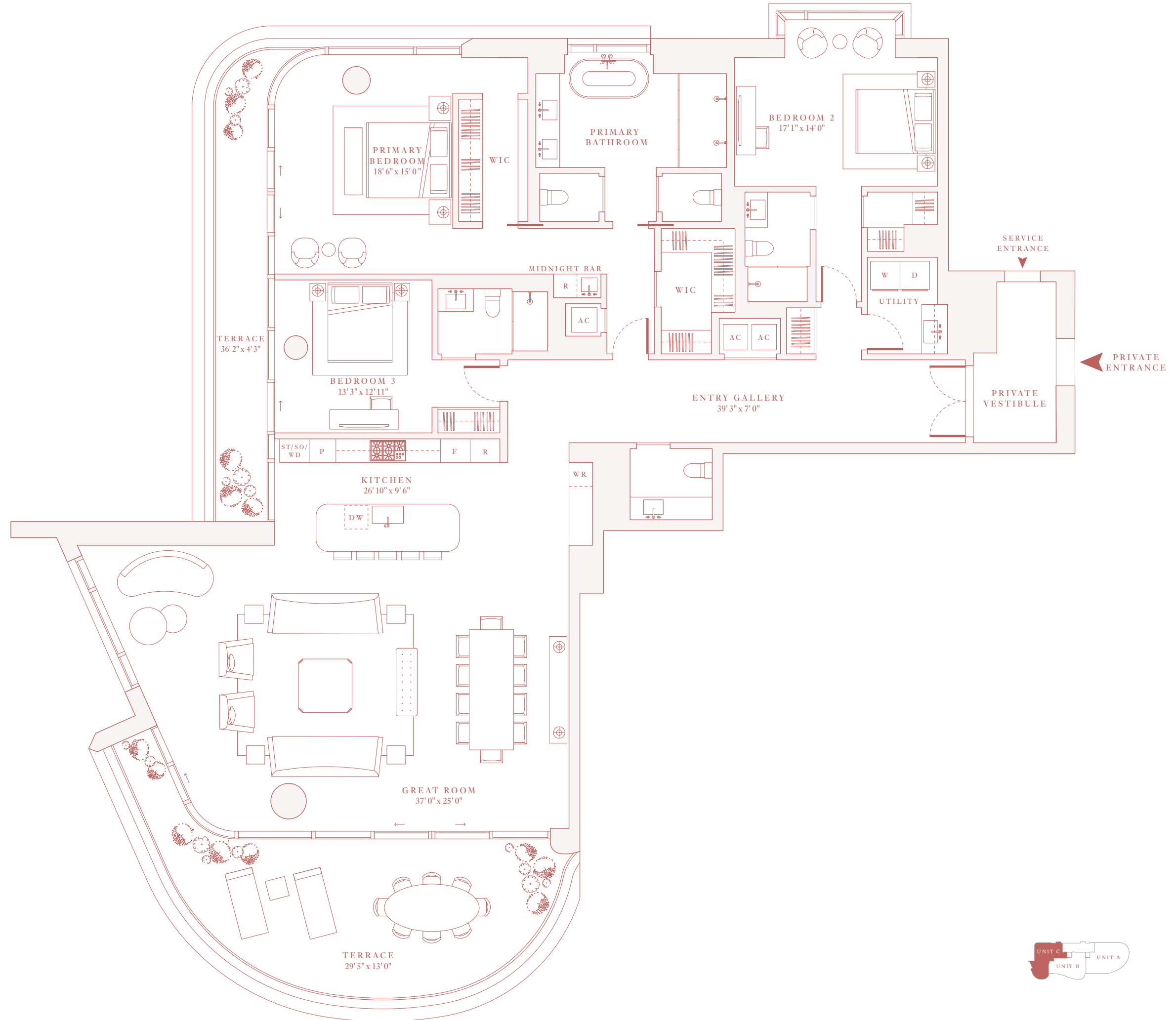

Stated square footages and dimensions are measured to the exterior boundaries of the exterior walls and the centerline of interior demising walls and in fact vary from the square footage and dimensions that would be determined by using the description and definition of the "Unit" set forth in the Declaration (which generally only includes the interior airspace between the perimeter walls and excludes all interior structural components and other common elements). This method is generally used in sales materials and is provided to allow a prospective buyer to compare the Units with units in other condominium projects that utilize the same method. For your reference, the area of the Unit, determined in accordance with these defined unit boundaries is described on Exhibit 3 to the Declaration. Measurements of rooms set forth on this floor plan are generally taken at the farthest points of each given room (as if the room were a perfect rectangle), without regard for any cutouts or variations. Accordingly, the area of the actual room will typically be smaller than the product obtained by multiplying the stated length and width. All dimensions are estimates which will vary with actual construction, and all floor plans, specifications and other development plans are subject to change and will not necessarily accurately reflect the final plans and specifications for the development.



# No. 19

## THE TOWER

### FLOOR NINE RESIDENCE A

Five Bedrooms  
Six Bathrooms  
Powder Room  
Staff Room

### INTERIOR

4,693 square feet  
436 square meters

### EXTERIOR

649 square feet  
60 square meters

### TOTAL

5,342 square feet  
496 square meters  
161'-1" linear feet of glass

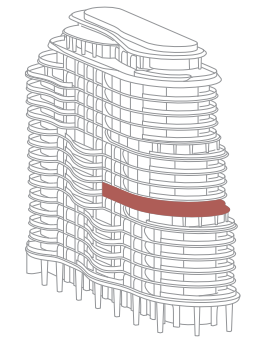
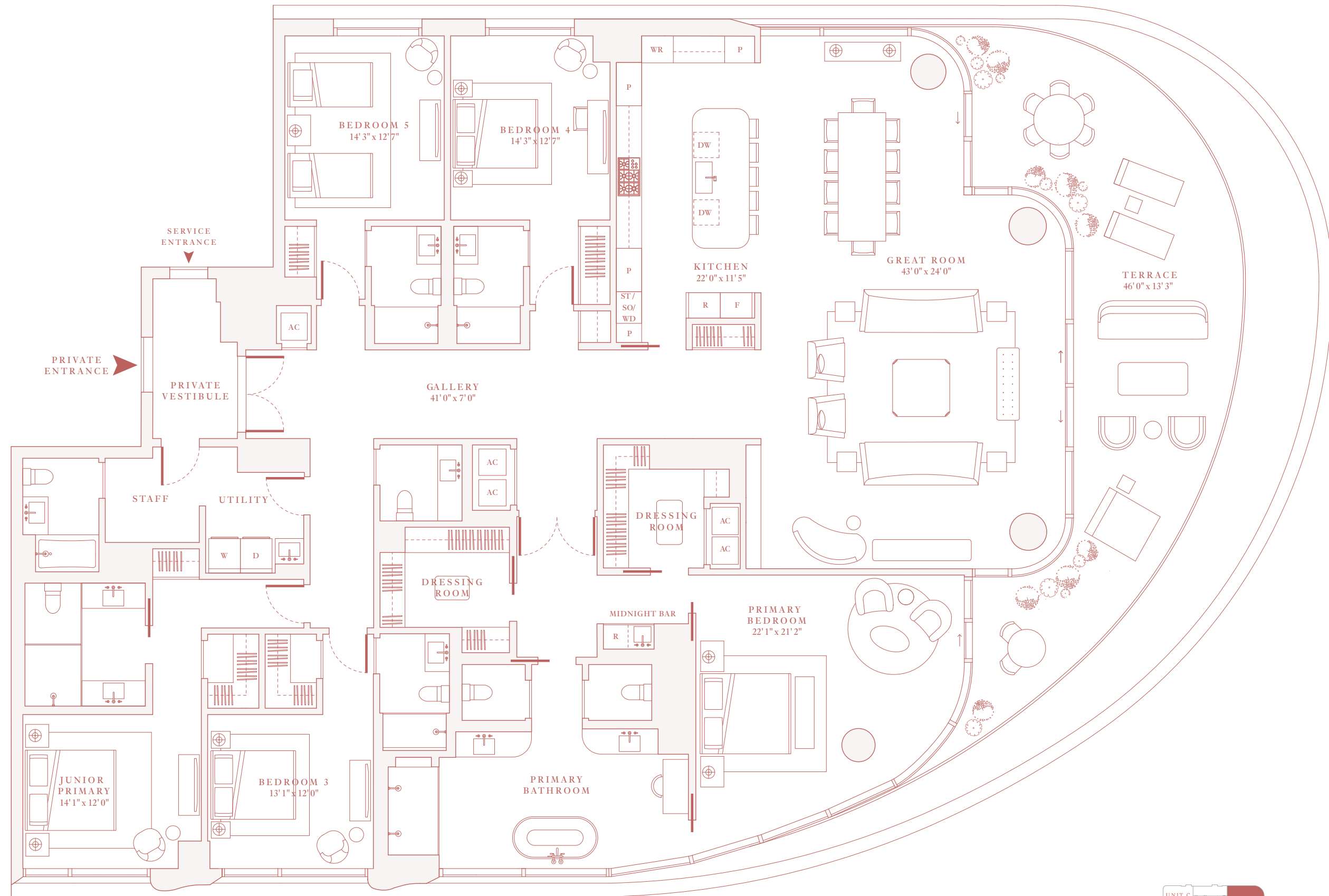

OCEAN



Stated square footages and dimensions are measured to the exterior boundaries of the exterior walls and the centerline of interior demising walls and in fact vary from the square footage and dimensions that would be determined by using the description and definition of the "Unit" set forth in the Declaration (which generally only includes the interior airspace between the perimeter walls and excludes all interior structural components and other common elements). This method is generally used in sales materials and is provided to allow a prospective buyer to compare the Units with units in other condominium projects that utilize the same method. For your reference, the area of the Unit, determined in accordance with these defined unit boundaries is described on Exhibit 3 to the Declaration. Measurements of rooms set forth on this floor plan are generally taken at the farthest points of each given room (as if the room were a perfect rectangle), without regard for any cutouts or variations. Accordingly, the area of the actual room will typically be smaller than the product obtained by multiplying the stated length and width. All dimensions are estimates which will vary with actual construction, and all floor plans, specifications and other development plans are subject to change and will not necessarily accurately reflect the final plans and specifications for the development.



# No. 23

## THE TOWER

### FLOOR EIGHT RESIDENCE B

Three Bedrooms  
Three Bathrooms  
Powder Room

### INTERIOR

3,197 square feet  
297 square meters

### EXTERIOR

522 square feet  
55 square meters

### TOTAL

3,719 square feet  
352 square meters  
63'-11" linear feet of glass

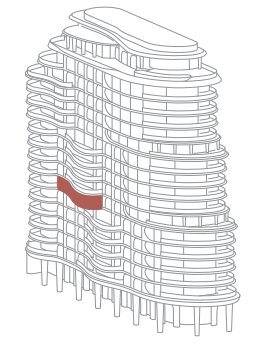
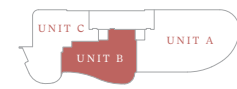
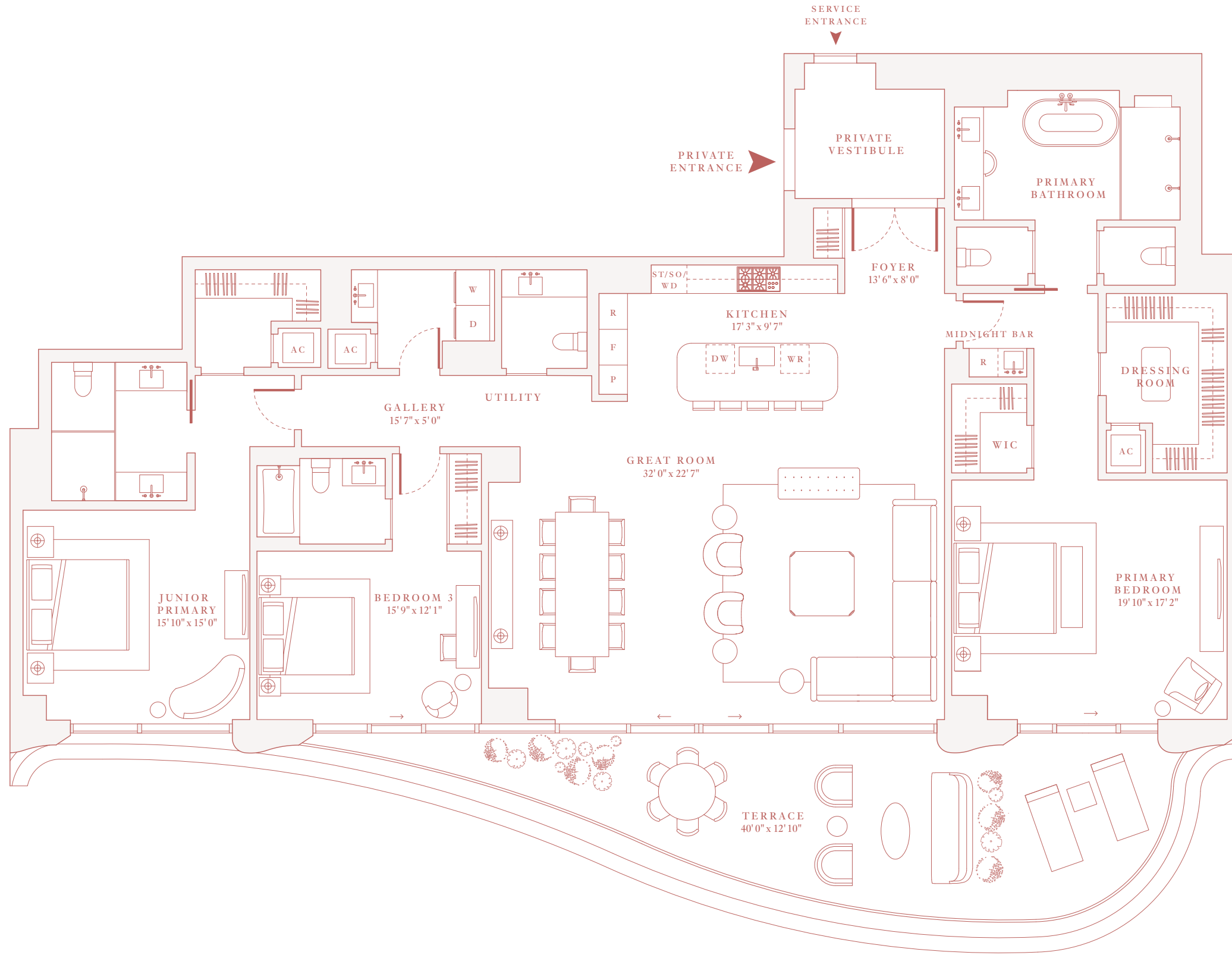

OCEAN



Stated square footages and dimensions are measured to the exterior boundaries of the exterior walls and the centerline of interior demising walls and in fact vary from the square footage and dimensions that would be determined by using the description and definition of the "Unit" set forth in the Declaration (which generally only includes the interior airspace between the perimeter walls and excludes all interior structural components and other common elements). This method is generally used in sales materials and is provided to allow a prospective buyer to compare the Units with units in other condominium projects that utilize the same method. For your reference, the area of the Unit, determined in accordance with these defined unit boundaries is described on Exhibit 3 to the Declaration. Measurements of rooms set forth on this floor plan are generally taken at the farthest points of each given room (as if the room were a perfect rectangle), without regard for any cutouts or variations. Accordingly, the area of the actual room will typically be smaller than the product obtained by multiplying the stated length and width. All dimensions are estimates which will vary with actual construction, and all floor plans, specifications and other development plans are subject to change and will not necessarily accurately reflect the final plans and specifications for the development.





# No. 31

## THE TOWER

### FLOOR SIX RESIDENCE C

Two Bedrooms  
Two Bathrooms  
Powder Room

### INTERIOR

2,482 square feet  
230 square meters

### EXTERIOR

395 square feet  
37 square meters

### TOTAL

2,877 square feet  
267 square meters  
63'-1" linear feet of glass

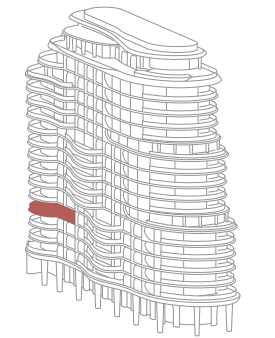
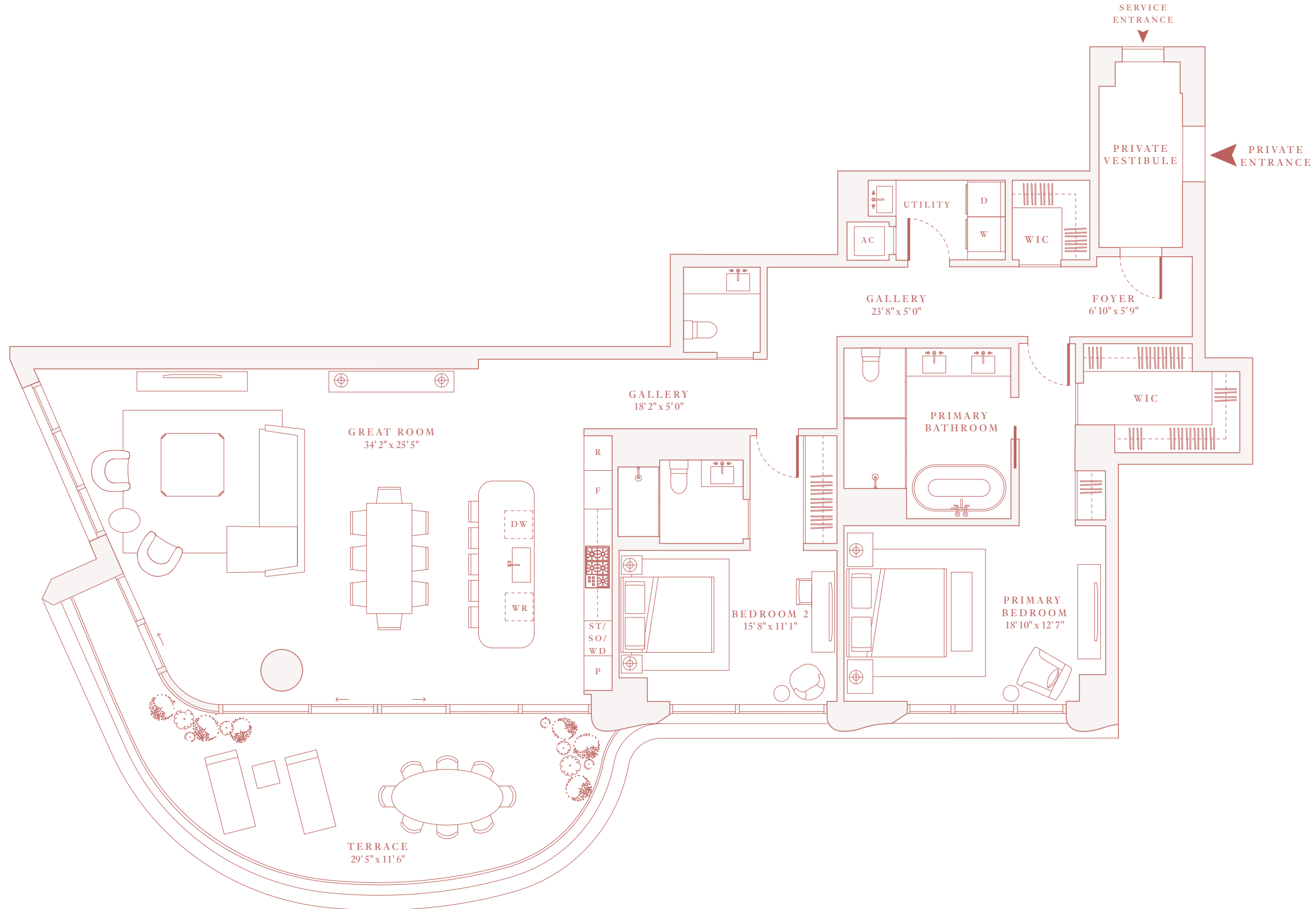

OCEAN



# No. 37

## THE TOWER

### FLOOR FOUR RESIDENCE A

Four Bedrooms  
Five Bathrooms  
Powder Room  
Staff Room

### INTERIOR

4,456 square feet  
414 square meters

### EXTERIOR

623 square feet  
58 square meters

### TOTAL

5,079 square feet  
472 square meters  
132'-8" linear feet of glass

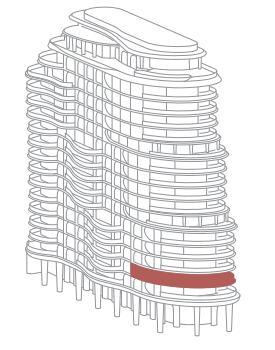
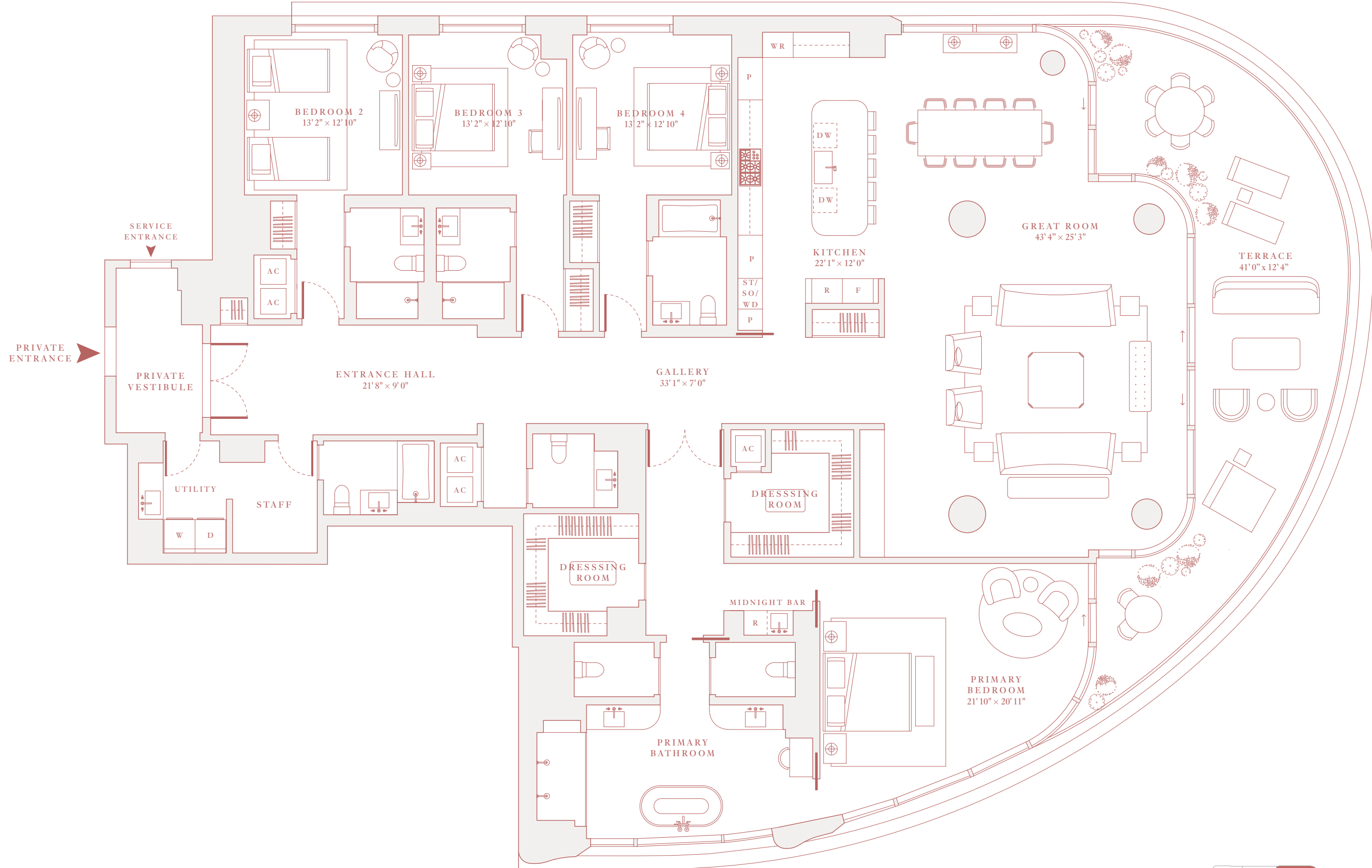

OCEAN



Stated square footages and dimensions are measured to the exterior boundaries of the exterior walls and the centerline of interior demising walls and in fact vary from the square footage and dimensions that would be determined by using the description and definition of the "Unit" set forth in the Declaration (which generally only includes the interior airspace between the perimeter walls and excludes all interior structural components and other common elements). This method is generally used in sales materials and is provided to allow a prospective buyer to compare the Units with units in other condominium projects that utilize the same method. For your reference, the area of the Unit, determined in accordance with these defined unit boundaries is described on Exhibit 3 to the Declaration. Measurements of rooms set forth on this floor plan are generally taken at the farthest points of each given room (as if the room were a perfect rectangle), without regard for any cutouts or variations. Accordingly, the area of the actual room will typically be smaller than the product obtained by multiplying the stated length and width. All dimensions are estimates which will vary with actual construction, and all floor plans, specifications and other development plans are subject to change and will not necessarily accurately reflect the final plans and specifications for the development.

0' 4' 8' 16'



# No. 42

## THE TOWER

### FLOOR THREE RESIDENCE B

Three Bedrooms  
Three Bathrooms  
Powder Room

#### INTERIOR

3,123 square feet  
290 square meters

#### EXTERIOR

478 square feet  
44 square meters

#### TOTAL

3,601 square feet  
334 square meters  
68'-7" linear feet of glass

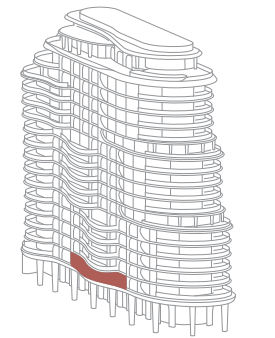
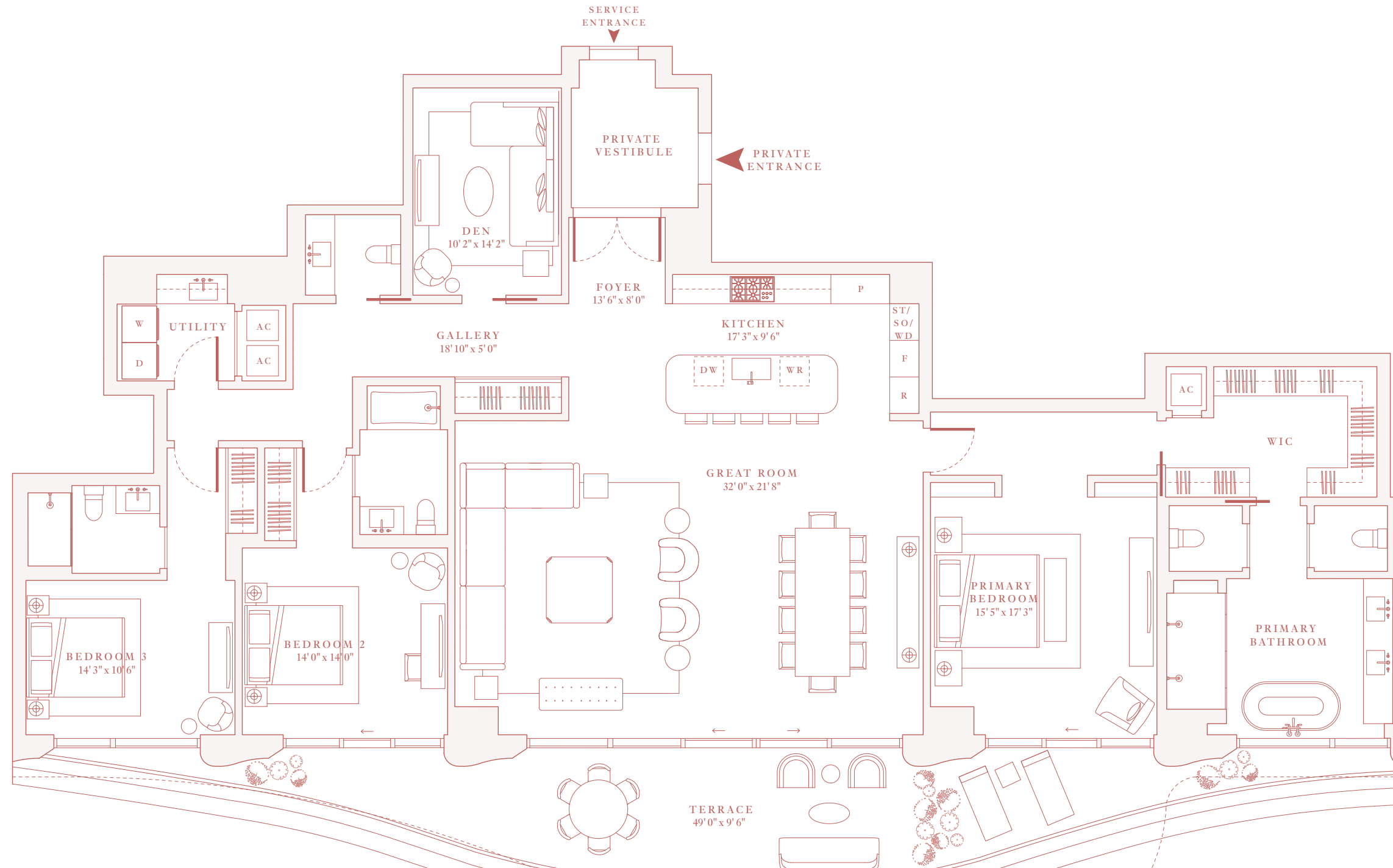

Stated square footages and dimensions are measured to the exterior boundaries of the exterior walls and the centerline of interior demising walls and in fact vary from the square footage and dimensions that would be determined by using the description and definition of the "Unit" set forth in the Declaration (which generally only includes the interior airspace between the perimeter walls and excludes all interior structural components and other common elements). This method is generally used in sales materials and is provided to allow a prospective buyer to compare the Units with units in other condominium projects that utilize the same method. For your reference, the area of the Unit, determined in accordance with these defined unit boundaries is described on Exhibit 3 to the Declaration. Measurements of rooms set forth on this floor plan are generally taken at the farthest points of each given room (as if the room were a perfect rectangle), without regard for any cutouts or variations. Accordingly, the area of the actual room will typically be smaller than the product obtained by multiplying the stated length and width. All dimensions are estimates which will vary with actual construction, and all floor plans, specifications and other development plans are subject to change and will not necessarily accurately reflect the final plans and specifications for the development.

